

Jensen Surveying & Mapping S.C.
45 S. Wisconsin St. P.O. Box 322
Elkhorn, Wisconsin. 53121
(414) 723-3434

PLAT OF SURVEY
OF

Unit I of CLEAR SKY LODGE, a Condominium
located in Government Lot 4, Section 18,
T.I.N., R.17 E., Village of Fontana-on-
Geneva Lake, Walworth County, Wisconsin.

SURVEYED FOR: PETER GERARDO
518 SOUTH SHORE DRIVE
FONTANA, WISCONSIN. 53125

REVISED 3-24-94 FOR: THE RAULAND AGENCY
118 KENOSHA STREET
WALWORTH, WIS. 53184

Note: This survey plat is not
certified unless signed
and sealed in red ink.

Bearings are referenced to
the Condominium Plat

SCALE: 1" = 40'

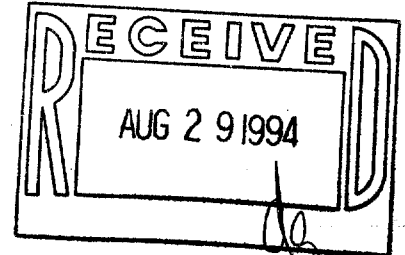

		CURVE DATA		CHORD	CHORD BEARING
CI	DELTA	RADIUS	ARC		
C1	167 30 19	30.00	87.71	59.64	N36 07 43 E
C4	96 37 08	30.00	50.59	44.80	N00 41 07 E

LEGEND

- = Found Iron Rod
- NA = Set Iron Rod 3/4" Dia.
- = FOUND IRON PIPE
- = FOUND CONCRETE MONUMENT
- ✱ = FOUND P.K. NAIL

MAPPING DATE 5/24/90

SURVEYED 8/11/88
REVISED 10/12/92.
REVISED 3-24-94

DETAIL A

NOT TO
SCALE.

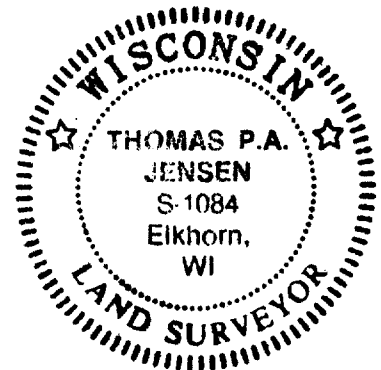
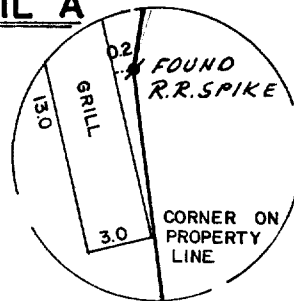

I, Thomas P. A. Jensen, Wisconsin Registered Land Surveyor,
hereby certify that this survey was performed by me, or under my
direction, in full compliance with the owner's/agent's
instructions, and that this map is an accurate representation
thereof to the best of my knowledge and belief.

Thomas P. A. Jensen
Thomas P. A. Jensen, R.L.S.-1084
JENSEN SURVEYING & MAPPING, S.C.

Copyright © 1990 by Jensen Surveying & Mapping S.C.

All rights reserved. No part of this survey plat may be
reproduced or transmitted in any form by any means - graphic,
electronic, or mechanical, including photocopying, tracing, or
information storage and retrieval systems - without permission in
writing from Thomas P.A. Jensen, Jensen Surveying & Mapping S.C.

S-1379

1994.018

1992.129

JOB NO. 1990.062

SC-1